



English

Français

Deutsch

Italiano

Español

中文

MoshiMoshi03 *Bluetooth*[®] Wireless (MM03) **Handset+Base**

Instruction Manual
Manuel d'instruction
Bedienungsanleitung
Manuale di istruzioni
Manual de instrucciones
説明書

WELCOME

Thank you for buying a MoshiMoshi handset, you will love this new experience of comfortable and radiation safe talk.

For the most up-to-date information, be sure to check our Web site at www.nativeunion.com

WHAT YOU GET IN THIS PACKAGE

1. One MOSHIMOSHI03 *Bluetooth*® Wireless handset
2. One MOSHIMOSHI03 base
3. One multi-country AC adaptor with 3 exchangeable power supply plugs for Europe, UK, North America and Asia.
4. One Micro-USB / USB Cable
5. One silicon mobile phone mat
6. One instruction Manual

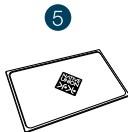
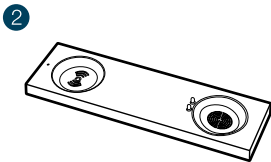

LOCATION OF CONTROLS

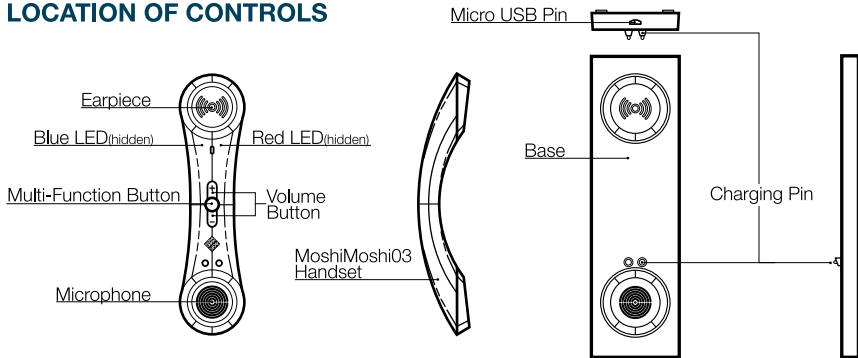

How to use the MoshiMoshi03 *Bluetooth*® Wireless Handset + Base:

PLEASE READ THESE INSTRUCTION CAREFULLY before using your new handset

IMPORTANT SAFETY INSTRUCTIONS READ BEFORE OPERATING EQUIPMENT

This product was designed and manufactured to meet strict quality and safety standards. There are, however, some installation and operation precautions which you should be particularly aware of :

1. Read these instructions.
2. Keep these instructions.
3. Heed all warnings.

4. Follow all instructions.
5. Do not use this apparatus near water.
6. Clean only with dry cloth.
7. Do not install near any heat sources such as radiators, heat registers, stoves, or other apparatus (including amplifiers) that produce heat
8. Only use attachments/accessories specified by the manufacturer.

You must first locate and identify the buttons : please check the “Location of controls” section to help you.

CONNECTING YOUR MOSHIMOSHI03 TO YOUR MOBILE PHONE

STEP1

CHARGE YOUR MOSHIMOSHI03

- a. Connect the micro USB pin of the Micro USB / USB cable provided to the base of the MoshiMoshi03
- b. Connect the USB pin of the Micro USB / USB cable provided to the AC power adaptor

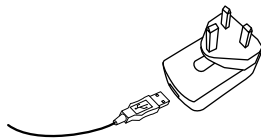
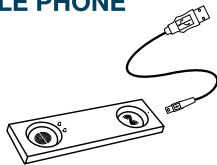

c. Plug the AC adaptor into a power outlet.

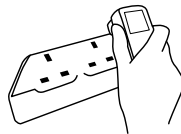

d. Finally, place the handset in the charging base to charge the battery*

* The MoshiMoshi03 comes with a build-in rechargeable battery. It takes two or three hours to fully recharge the battery.

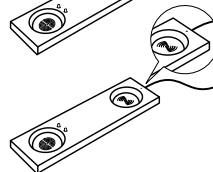
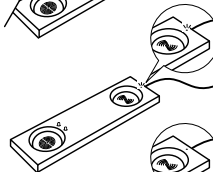
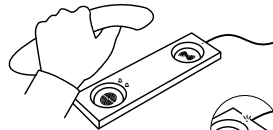

- During charging :
The WHITE led of the base will turn on

- When the battery is fully charged :
The WHITE led of the base will turn off

When your MOSHIMOSHI03 is low battery, the RED led of the handset will start blinking. Place it back to the base to charge it.

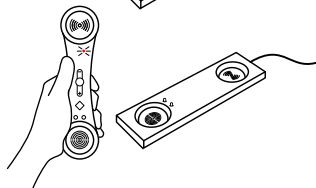

STEP2

TURN YOUR MOSHIMOSHI03 ON

To turn on your MOSHIMOSHI03, you must press and hold the MFB (O) button for 3-5 seconds.

When your MOSHIMOSHI03 is on, you will hear a sound and the **BLUE** led will turn on

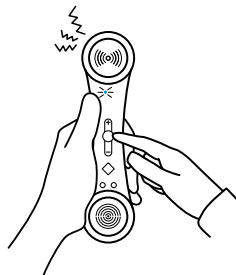

STEP3

TURN YOUR MOSHIMOSHI03 OFF

To turn off your MOSHIMOSHI03, you must press and hold the MFB (O) button for 3-5 seconds.

When your MOSHIMOSHI03 is off, you will hear a sound and the **BLUE** led will turn off.

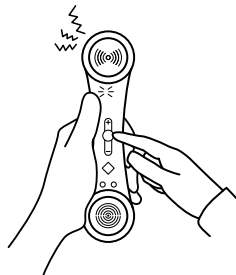

STEP4 PAIRING THE MOSHIMOSHI03 *BLUETOOTH*® WIRELESS HANDSET WITH YOUR *BLUETOOTH*® WIRELESS TECHNOLOGY MOBILE PHONE.

First of all, you must make sure that your mobile phone has *Bluetooth*® Wireless capability. If you are not sure whether it does, please consult the user's instructions.

IMPORTANT : Please note that your MoshiMoshi03 must be power off before starting the pairing process.

a) To pair your MoshiMoshi03 *Bluetooth*® Wireless handset with your mobile phone, you must press and hold the MFB (O) button for 5 seconds, until you hear a sound and you see the **RED** and **BLUE** led flashing alternatively. Your MoshiMoshi03 *Bluetooth*® Wireless handset is now ready to be paired.

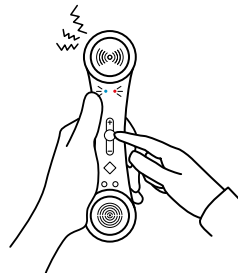

b) Make sure the *Bluetooth*® Wireless function is activated on your mobile phone, and instruct your mobile phone to search for new *Bluetooth*® devices. (check the user's instructions of your mobile phone if you need more information about this)

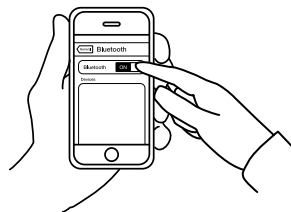

c) Place your MoshiMoshi03 *Bluetooth*® Wireless handset within 1 meter away from your mobile phone.

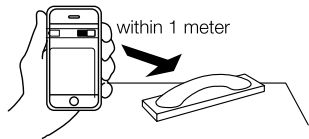

d) Your mobile phone should search for all *Bluetooth*® devices and the name “MoshiMoshi03” should appear on the *Bluetooth*® device list.

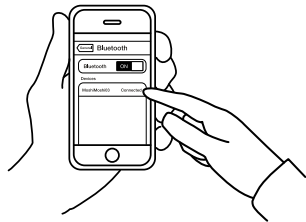

e) Select “MOSHIMOSHI03” and enter “0000” if a password is required.

The MOSHIMOSHI03 will make a sound and the blue led will blink slowly, indicating the pairing process is now completed and the phone connected.

You will also see a white LED blinking slowly on the back of the handset. This LED is a visual indication, to tell you that the MOSHIMOSHI03 is now connected with your mobile phone.

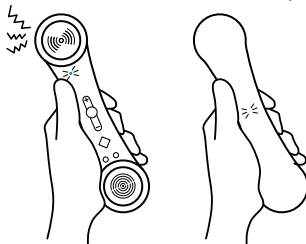

You can use now your MOSHIMOSHI03 !

ATTENTION : The *Bluetooth*® Wireless technology signal reception works up to a 10m range (open area). If your mobile phone move away further this limit, the *Bluetooth*® connection will stop and the MoshiMoshi03 will be automatically disconnected. The Blue led and the top white led will both turn off and to indicate this disconnection.

USE YOUR MOSHIMOSHI03 WITH YOUR MOBILE PHONE

MAKING A CALL

To make a call with your MOSHIMOSHI03 simply do as you normally do it, with your mobile phone, except that when the call connects, you will now speak and listen through the MOSHIMOSHI03.

ANSWERING AN INCOMING CALL

To answer a call on your MOSHIMOSHI03 simply pick up the handset from the base or press the MFB (O) button once.

You may, should you prefer, also answer the call directly on your mobile phone as usual.

However, once you have done this, you will still be connected on your MOSHIMOSHI03.

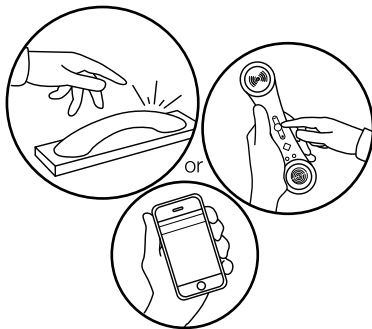

DISCONNECTING A CALL

To hang-up a call on your MOSHIMOSHI03, simply place the handset back on the base or press the MFB (O) button once, and you will be disconnected.

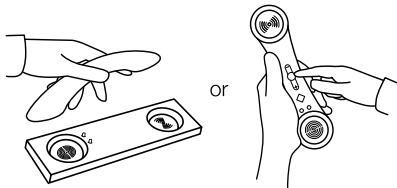

INFORMATION: MOSHIMOSHI03 enables a *Bluetooth*® connection to stay paired even if the MOSHIMOSHI03 handset or the mobile phone is switched off and on again. This feature allows instant *Bluetooth*® re-connection when either one of the Bluetooth device is switched off and on again.

Please also note that MOSHIMOSHI03 can memorize up to 4 devices. MOSHIMOSHI03 will then auto-reconnect to the last connected device. If last connected device is not available, it will try to connect to the next device on the list.

OTHER FUNCTIONS OF THE MOSHIMOSHI03 *BLUETOOTH*® WIRELESS HANDSET

REJECTING INCOMING CALLS

To reject a call on your MOSHIMOSHI03, press and hold for 1.5s the MFB (O) button

VOLUME CONTROL

During a call, to adjust the volume on your MOSHIMOSHI03, simply locate the volume control + and – buttons and press “+” to increase the volume or “-” to decrease it.

REDIAL LAST NUMBER

To redial the last number called on your MOSHIMOSHI03, just double press the MFB (O) button.

END ACTIVE CALL AND ACCEPT WAITING CALL

During a call, to end the active call and accept the waiting incoming call on your MOSHIMOSHI03, short press the MFB (O) button.

HOLD ACTIVE CALL AND ACCEPT WAITING CALL

During a call, to hold your actual active call and accept the waiting incoming call on your MOSHIMOSHI03, double press the MFB (O) button. Please do the same if you want to switch again between the two calls.

VOICE ACTIVATED DIALING

Your MoshiMoshi03 also support “voice activated” dialing with certain models of mobile phones. Before you use this function, you need to set up “voice-tags” on your mobile phone. To find out how to do this, please refer to the instruction manual of your mobile phone.

To make a voice activated call, press and hold for 1.5 second the volume + (+) button.

When you will hear a “bip”, you must tell the name you wish to call.

If your mobile phone has trouble recognizing the voice tag, please record again the voice-tag corresponding threw the MOSHIMOSHI03.

MUTE

During a call, press Volume + (+) and Volume – (-) buttons together to mute the microphone. Press again to unmute.

CLEAR PAIRED DEVICE LIST

To clear the list of all paired devices, press and hold Volume – (-) button for 7 seconds

CHOOSE YOUR MOSHIMOSHI03 RINGTONE

You can define how you want your MoshiMoshi03 to ring on incoming calls. You have a choice of 4 ringtones.

- a) To enter the ringtone selection mode on you MoshiMoshi03, press and hold for 2 seconds Volume + (+) and Volume - (-) buttons together. Your MoshiMoshi03 will then play the first ringtone repeatedly.
- b) To select a ringtone, short press the MFB (O) button and the Volume + (+) button together. Each press of those combine buttons will play the next ringtone.
- c) To adjust the volume of the selected ringtone, short press the Volume + (+) or Volume - (-) button.
- d) To confirm the selected ringtone and leave the ringtone selection mode, press and hold for 2 seconds Volume + (+) and Volume - (-) buttons together.

INFORMATION: Please note that the MOSHIMOSHI03 also enables a *Bluetooth*[®] connection with any laptop or desktop (Mac or PC) featured with a *Bluetooth*[®] Wireless Technology (supporting HS or HF profile) to work with Skype, Google Talk or other VOIP services.

To connect your MOSHIMOSHI03 with your computer, you need to go threw the pairing process (please refer to the instruction manual of your computer) as explain previously, please see PAIRING THE MOSHIMOSHI03 *BLUETOOTH*[®] WIRELESS HANDSET WITH YOUR *BLUETOOTH*[®] WIRELESS TECHNOLOGY MOBILE PHONE.

If you experience some problem with the sound, such as hearing the sound coming out from the computer instead of your MOSHIMOSHI03, please check that MOSHIMOSHI03 has been selected on the “Audio Preferences” of your computer or of your VOIP software.

TROUBLE SHOOTING

No Connection between your MoshiMoshi03 and your Mobile Phone ?

The first thing to do is to make sure that your mobile phone and the MoshiMoshi03 have recognized each other and are properly paired together.

The next thing to check is if the MoshiMoshi03 and your mobile phone are within a 10m range maximum (open area)

SPECIFICATIONS

Bluetooth specs	V2.1 + EDR
Radio Frequency Range	2.4 – 2.4835GHz
Output power class	Class 2
Maximum range (open space)	10 meters
Supported profiles	HSP, HFP
Type of Battery	Lithium-ion Polymer
Talk Time/ working Time	6 hrs
Standby time	120hrs
Audio Output	0.25W RMS
Power Supply	AC100V-240V 50/60Hz Adaptor
Operating Temperature	0 – 45°C

If you are having any problem getting your MoshiMoshi03 to work, please go www.nativeunion.com to for further information or consult your retailer.

If neither of those solve the problem, please feel free to e-mail us at troubleshooting@nativeunion.com, and we will do our best to help you.

LIMITED WARRANTY

If the product appears to be damaged or does not function properly, please follow the advice in this booklet.

If you can not find any solution in this booklet, please go to www.nativeunion.com/support for instructions about how to obtain warranty service.



Regulations According to R&TTE
Declaration of Conformity

Native Union declares that MOSHIMOSHI03 is in compliance with the essential requirements and other relevant provisions of Directive 1999/5/EC, in conformity with the following standards: EN300 328, EN301 489-1, EN301 489-17 and EN60950-1

The declaration of conformity is available at :
Design Pool Ltd
Ground Floor
13 Western Street
Sai Ying Pun
Hong Kong



FCC COMPLIANCE STATEMENT

This device complies with Part 15 of FCC Rules. Operation is subject to the following two conditions : (1) this device must accept any interference received, including interference that may cause undesired operation.

Changes or modifications not expressly approved by the part responsible for compliance could void the user's authority to operate the equipment. The manufacturers are not responsible for any radio or TV interference caused by unauthorized modification or incorrect installation to this equipment.

FCC ID : XXXXXXXXX

FCC NOTICE (USA)

As specified in Part 15 of the FCC Rules, this equipment complies within the limits of a Class B digital device. These restrictions provide sufficient protection against radio and TV interference in residential areas. However, even during normal operation, this device may cause TV or radio interference. In attempting to eliminate some or all interference, you should try one or more of the following corrective measures:

1. Increase the distance between the device and the radio and/or TV
2. Try a different outlet on various electrical circuits for the device, the radio and/or TV.
3. Reposition the receiving antenna



BLUETOOTH

The Bluetooth word mark and logos are owned by the Bluetooth SIG, Inc. And any use of such marks by Native Union is under licence. Bluetooth QDID: BXXXXXX



Disposal of old electrical and electronic equipment :

After the implementation of the European Directive 2002/96/EU in the national legal system, the following applies:

Electrical and electronic devices may not be disposed of with domestic waste. Consumers are obliged by law to return electrical and electronic devices at the end of their service lives to the public collecting points set up for this purpose or point of sale. Details to this are defined by the national law of the respective country. This symbol on the product, the instruction manual or the package indicates that a product is subject to these regulations. By recycling, reusing the materials or other forms of utilizing old devices, you are making an important contribution to protecting our environment.

Designed in France by David Turpin
www.nativeunion.com

Spec. is subject to change without prior notice.

© Native Union and Native Union Logo are registered trademarks of Design Pool Ltd
All other trademarks and registered trademarks are the property of their respected owners.

Other product and company names mentioned herein may be trademarks of their respective companies.

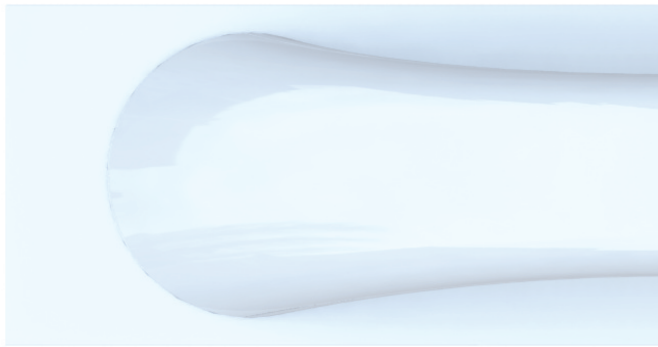

www.nativeunion.com

Assembled in China