



powerstation®

Made for smartphones, tablets, and other
USB-C & USB-A compatible devices

USER MANUAL

Welcome

Thank you for purchasing the mophie powerstation mini, powerstation, powerstation XL or powerstation XXL battery. Your powerstation battery is a compact yet powerful mobile charging solution for your tablet, smartphone, wearables and other USB devices. Now you will be able to travel great distances and be the master of your own destiny, no longer bound by the limitations of your device's internal battery!

Package Contains

- powerstation mini, powerstation, powerstation XL or powerstation XXL portable battery
- USB-A to USB-C cable
- Quick-start guide

Features

Here's a rundown of why your powerstation mini, powerstation, powerstation XL or powerstation XXL battery is so great:

- High-density, high-output portable battery charges devices at fast speeds—up to 3 amps via the USB-C port (up to 2.4 amps for the powerstation mini).
- Additional USB-A output ports let you charge multiple devices at the same time.
- USB-C input/output port recharges the portable battery at fast speeds—up to 3A with a

compatible wall adapter (up to 2.4 amps for the powerstation mini).

- Track battery power at a glance with the integrated four-light LED status indicator. You can keep tabs on charging status and current battery life. Know before you go!
- mophie's smart adaptive charging technology identifies your connected device and always delivers the fastest, most efficient charging speeds available.
- Digital Power Management circuitry provides built-in short-circuit, overcharge and temperature protection. Safety first!

Compatibility

The mophie powerstation mini, powerstation, powerstation XL and powerstation XXL batteries are designed to work with most popular USB devices and wearables.

- If you experience any issues with charging your device, ensure that the powerstation battery is fully charged and check the FAQ section on this website.

No matter what device you have, carefully read through the Warning section in this manual and in the quick-start guide included with your battery before using it.

Charging your powerstation battery

IMPORTANT: Before using your powerstation mini, powerstation, powerstation XL or powerstation XXL battery for the first time, fully charge it (so that pressing the charge status button lights all four status LEDs).

To charge your battery, use the supplied cable to connect the battery's USB-C input/output port to a power source with a USB output, such as the wall adapter included with your smartphone or other device.

powerstation mini;
powerstation:

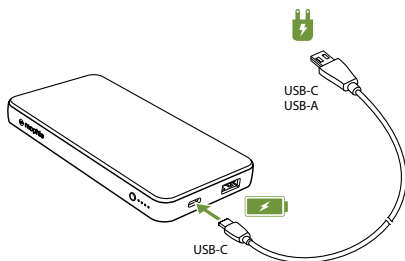

powerstation XL;
powerstation XXL:

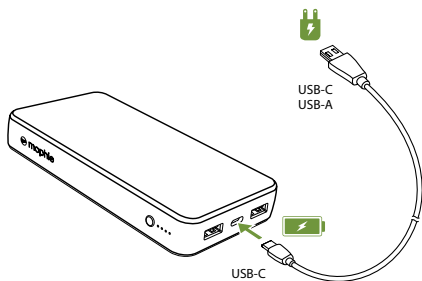

Charging your device

Connect the cable that came with your device to one of the powerstation mini, powerstation, powerstation XL or powerstation XXL battery's ports and to your device. All of the battery's ports are available simultaneously, so you can charge multiple devices at the same time. Press the status button for 3 seconds to begin charging.

powerstation mini;
powerstation:

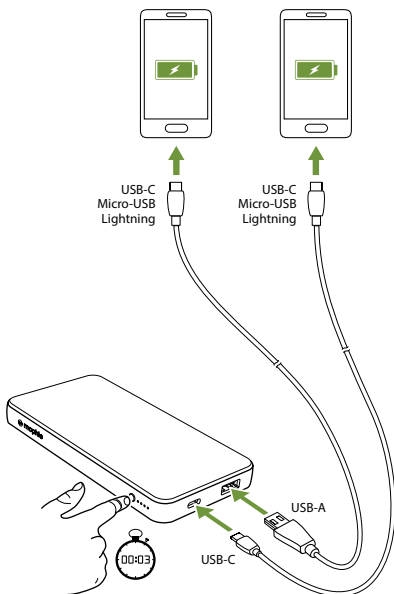

powerstation XL;
powerstation XXL:

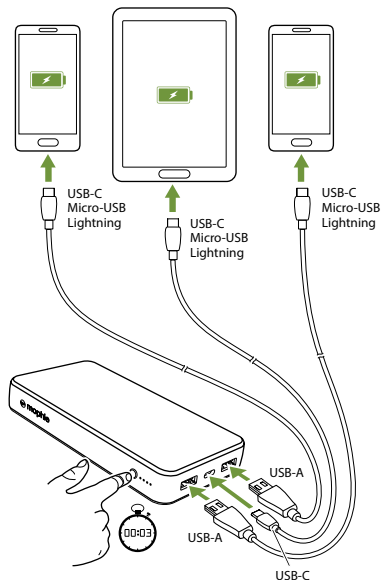

If you have USB-C devices, connect them to the powerstation, powerstation XL or powerstation XXL battery's USB-C connector for faster charging (up to 3 amps).

Priority+ charging

When you're recharging your powerstation mini, powerstation, powerstation XL or powerstation XXL

battery, Priority+ charging provides power to a connected device first before the battery starts to recharge. Priority+ charging is available at the USB-A port that is marked with the following icon:



powerstation mini;
powerstation:

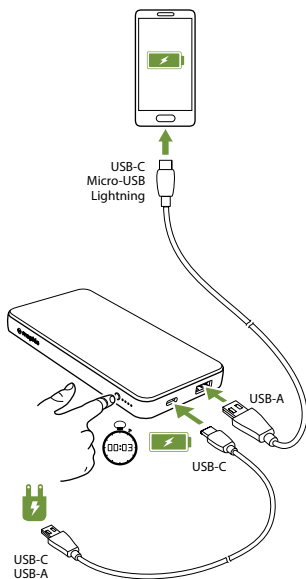

powerstation XL;
powerstation XXL:

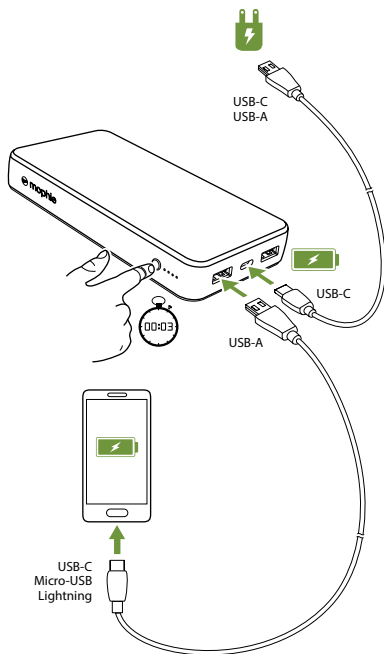

Checking your battery's charging status

Press the status button on your powerstation mini, powerstation, powerstation XL or powerstation XXL battery and the status LEDs will indicate its charge level. Four LEDs means that the battery is fully charged, while one LED means that it's almost empty. Know before you go!

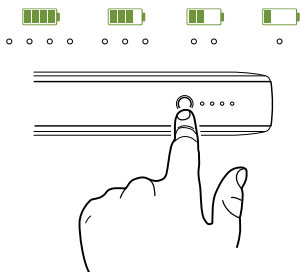

Taking care of your powerstation battery

- Keep your battery dry and away from moisture and corrosive materials.
- Do not clean your battery with harsh chemicals, soaps or detergents. Just wipe the case with a soft, water-dampened cloth.
- Make sure the battery's charging ports do not become contaminated with lint or other debris. Use a canned-air type of product periodically to ensure that the port openings are clear.

- Recharge your battery once every three months when not in use. If you plan on putting it away, fully charge it first (so that pressing the status button lights all four charge status LEDs).

Warranty

At mophie, we are dedicated to making the best quality products. To back this up, this product is warranted for 2 years. For full details regarding warranty terms and exclusions, please visit: mophie.com/warranty. This warranty does not affect any statutory rights that you may be entitled to. Keep a copy of your purchase receipt as proof of purchase. Be sure to register your product at mophie.com.

Exclusions & Limitations

Except for the limited warranty expressly set forth or to the extent restricted or prohibited by applicable law, mophie expressly disclaims any and all other warranties express or implied, including any warranty of quality, merchantability, or fitness for a particular purpose, and you specifically agree that mophie shall not be liable for any special, incidental, indirect, punitive, or consequential damages for breach of any warranty of any type on any mophie product. In addition to and without limiting the generality of the foregoing disclaimers, the limited warranty does not, under any circumstances, cover the replacement or cost of any electronic device

or personal property inside or outside of the mophie product.

You may have additional warranty rights depending on your country, state, or province. Further, some countries, states, and provinces do not allow the exclusion or limitation of incidental or consequential damages or exclusions or limitations on the duration of implied warranties, so the above may not apply to you. If any provision of the warranty is found unlawful, void, or unenforceable, that provision shall be deemed severable and shall not affect any remaining provision.

Customer Service

Telephone: 1-888-8mophie (1-888-866-7443)

International: +1 (269) 743-1340

Web: www.mophie.com/cs

IMPORTANT SAFETY INSTRUCTIONS

Warning

Read all instructions and warnings prior to using this product. Improper use of this product may result in product damage, excess heat, toxic fumes, fire or explosion, for which damages you ("Purchaser"), and not mophie llc ("Manufacturer") are responsible.

- X-Ⓢ Before using your powerstation battery for the first time, fully charge it (so that pressing the charge status button lights all 4 status LEDs).
- X-Ⓢ Do not store device in high-temperature environment, including heat caused by intense sunlight or other forms of heat. Do not place device in fire or other excessively hot environments. Exposure to fire or temperature above 212°F (100°C) may cause explosion.
- X-Ⓢ This product should be operated only in open-air conditions. It should not be operated in an enclosed, unventilated space such as a carrying bag, pocket, purse or bedding. Failure to follow these instructions may damage the product by overheating.
- X-Ⓢ Be cautious of drops, bumps, abrasions, or other impacts to this product. If there is any damage to the product such as dents, punctures, tears, deformities, or corrosion due to any cause, discontinue use. Contact Manufacturer or dispose of it in an appropriate manner at your local battery-recycling center.
- X-Ⓢ Do not expose the portable battery to rain or snow.
- X-Ⓢ Do not use the portable battery in excess of its output rating. Overloading outputs above rating may result in a risk of fire or injury to persons.

- X Do not disassemble this product or attempt to re-purpose or modify it in any manner.
- X Do not attempt to replace any part of this device.
- X For questions or instructions for the various ways to charge this device, refer to the *Charging your powerstation battery* section of this user manual.
- X Use of a power supply or charger not recommended by mophie may result in a risk of fire or injury to persons.
- X If this device is accessible to or may be used by a minor, purchasing adult agrees to be solely responsible for providing supervision, instruction, and warnings. Purchaser agrees to defend, indemnify, and hold Manufacturer harmless for any claims or damages arising from unintended use or misuse by a minor.
- X All products have gone through a thorough quality assurance inspection. If you find that your device is excessively hot, is emitting odor, is deformed, abraded, cut, or is experiencing or demonstrating an abnormal phenomenon, immediately stop all product use and contact Manufacturer.
- X Never dispose of batteries in the garbage. Disposal of batteries in the garbage is unlawful under state and federal environmental laws and regulations. Always take used batteries to your local battery-recycling center.

- ✕ Switch off the portable battery when not in use. The portable battery will automatically switch off when disconnected from a device.

Legal

This product is meant for use only in conjunction with the appropriate device. Please consult your device packaging to determine whether this product is compatible with your particular device. Manufacturer is not responsible for any damages to any device incurred through the use of this product.

Manufacturer shall not in any way be liable to you or to any third party for any damages you or any third party may suffer as a result of use, intended or unintended, or misuse of this product in conjunction with any device or accessory other than the appropriate device for which this product is designed. Manufacturer will not be responsible for any damages you or any third party may suffer as a result of misuse of this product as outlined above. If you are responsible for product use with an unintended device and damages result from such use, you agree to indemnify Manufacturer for any resulting injuries to any third part(ies).

mophie, powerstation, Priority+, Stay Powerful, mophie loves you, the five-circles design, and the mophie logo are trademarks of mophie inc.

Lightning is a trademark of Apple Inc. USB-C is a trademark of USB Implementers Forum. All rights reserved. Patents: mophie.com/patents.

This device complies with part 15 of the FCC Rules and RSS-Gen of IC Rules. Operation is subject to the following two conditions: (1) This device may not cause harmful interference, and (2) this device must accept any interference received, including interference that may cause undesired operation.

NOTE: This equipment has been tested and found to comply with the limits for a Class B digital device, pursuant to part 15 of the FCC Rules. These limits are designed to provide reasonable protection against harmful interference in a residential installation. This equipment generates, uses, and can radiate radio frequency energy and, if not installed and used in accordance with the instructions, may cause harmful interference to radio communications. However, there is no guarantee that interference will not occur in a particular installation.

If this equipment does cause harmful interference to radio or television reception, which can be determined by turning the equipment off and on, the user is encouraged to try to correct the interference by one or more of the following measures:

- Reorient or relocate the receiving antenna.
- Increase the separation between the equipment and receiver.
- Connect the equipment into an outlet on a circuit different from that to which the receiver is connected.
- Consult the dealer or an experienced technician for help.

CAUTION: To comply with the limits of the Class B digital device, pursuant to Part 15 of the FCC Rules, this device must be used with certified peripherals and shielded cables. All peripherals must be shielded and grounded. Operation with non-certified peripherals or non-shielded cables may result in interference to radio or reception.

MODIFICATION: Any changes or modifications of this device could void the warranty.



WEEE DECLARATION:

All of our products are marked with the WEEE symbol; this indicates that this product must NOT be disposed of with other waste. Instead it is the user's responsibility to dispose of their waste electrical

and electronic equipment by handing it over to an approved re-processor, or by returning it to mophie, inc. for reprocessing. For more information about where you can send your waste equipment for recycling, please contact mophie, inc. or one of your local distributors.

THIS DEVICE CONFORMS TO UL STD. 60950-1.
CERTIFIED TO CSA STD. C22.2 NO. 60950-1. CONFORMS
TO UL SUBJECT STD. 2056.

 STAY POWERFUL[®]