

Dear customer,

Congratulations on purchasing a high-quality Rollei product. You have acquired a modern Negative and Slide Scanner with excellent technical features and respective accessories, which is particularly easy to operate.

Please study this information in detail, observing safety instructions, in particular.

The scanner comes with a 2-year warranty. You will need the enclosed warranty card and your sales receipt in the event of the Negative and Slide Scanner developing a fault. Keep these in a safe place together with the instruction manual.

Please include the instruction manual when passing on the scanner to a third party.



Note:

- Only use the scanner for the intended purposes. Where the scanner has been used for other purposes, resulting in damage, the warranty shall be invalidated. Injuries and damage to the environment can also only be avoided if used correctly.

Contents of box

The box contains the following components:

- Film scanner
- Negative Film Holder
- Positive Slide Holder
- 110 Film Holder
- Super 8
- AC/DC adapter
- USB cable
- Cleaning brush
- TV cable
- User Manual

Contents

- 1 Introduction
 - 1 Contents of box
 - 2 Contents

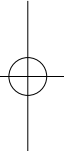
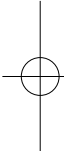
 - 3 1. Safety Instructions
 - 4 2. Description of parts
 - 5 3. Negative holder loading method
 - 6 4. Loading Slide
 - 7 5. Operation Guided
 - 7 5.1 Introduction of Menu
 - 7 5.2 Capture Picture
 - 10 5.3 Operation Guide
 - 11 5.4 How to playback captured picture
 - 12 5.5 Setting Language
 - 12 5.6 Resolution Choosing
 - 13 5.7 Formatting
 - 14 5.8 Connect to computer
 - 15 6. Product Specification
 - 16 7. Declaration
 - 16 8. Disposal
 - 17 9. Conformity
- 
- 

1. Safety Instructions



- Do not disassemble this unit.
- Do not touch inner part of the scanner after dropping or other damage suffering.
- Do stop using it if there is any problem with the scanner, such as smoke or smell while using.
- Do not clean the scanner with alcohol, gasoline, diluent and other organic solvent.
- Do not use it in many dusts with the damp environment.
- Do not overload the USB connections on your computer to avoid poor working of the scanner for overloading.
- Please use films of standard size.
- Cleaning: Please make sure the scanner is clean before using so as to produce a clean image.
- Non use period: The USB cord or adapter should be unplugged from the computer or plug seat when the unit is left unused for a long period of time.

To protect the machine and save energy, 30 minutes without continuous operation will automatically shut down in the state of power-on. Press the power button to turn again to normal use.

2. Description of parts



Film scanner



TV cable



USB cable



Adapter



User Manual

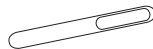

Brush

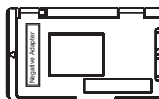

Negative Film Holder



Super 8



110 Film Holder

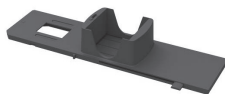

Positive Slide Holder

- Please use a clean product, if you use the cleaning brush to clean the backlight panel.

3. Negative holder loading method

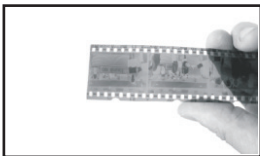

Hold up the negative toward the light. Face the right side of the negative to yourself.



Take out negative holder out. Let the side with "open" logo face yourself, and let the side with "◀" logo face down. Open the negative holder, then place negative into recessed area in the holder. Close the negative holder and press the edges so that it locks in place

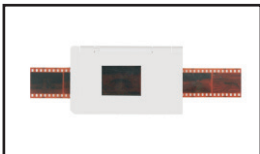

Insert the negative holder into the slot on the right side of the film scanner .



4. Loading Slides



Slide: Its light, shade and color of the slide are exactly as same as original image. Place the slide into the holder with the glossy side facing up and the image should be upright.

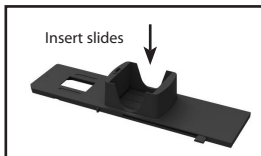

To select the desired thickness of the slide cartridge, push the slider in an up down motion along the groove.

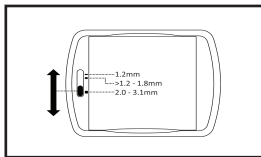

Thickness selection indicators are located at the top of the holder.

Hold it in the position as shown in the film scanner. Insert the slide holder into the slot on the right side of the film scanner.

5. Operation Guided

5.1 Introduction of Menu

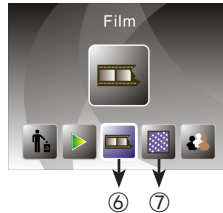
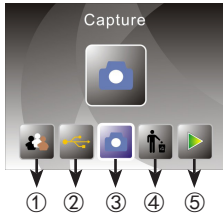

- ① Language mode
- ② USB mode
- ③ Capture mode

- ④ Format
- ⑤ Playback mode
- ⑥ Film Type

- ⑦ Resolution

5.2 Capture Picture

Before scanning please make sure the inner backlight panel is clean.

Note: You can use the provided brush to clean the screen.

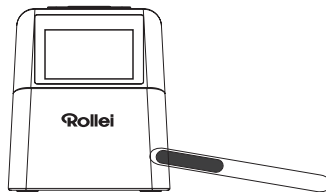

Rollei

In main Menu mode press OK/ENTER enter capture mode, then press Convert/Mode then press OK/Enter the picture would be captured.

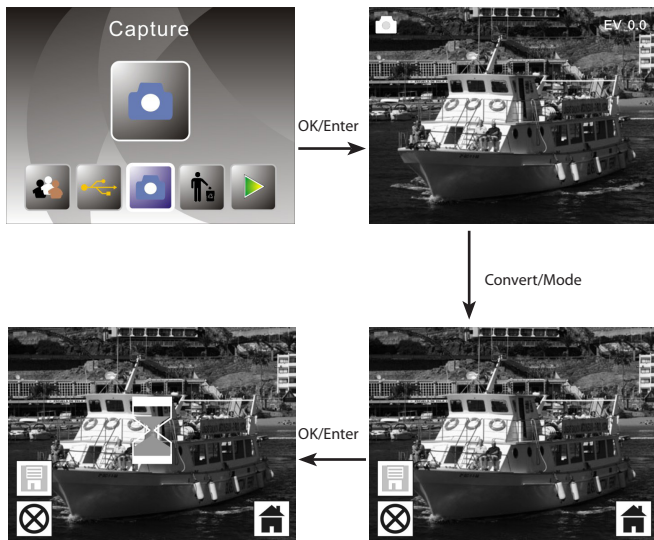

Before pressing to capture picture, you can press left button to mirror and press right button to flip the current picture. And you can press OK button to set Exposure.

Then press Convert/Mode button again back to main menu.

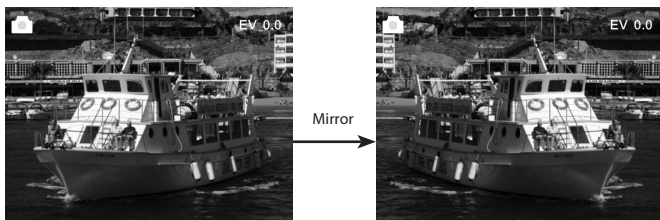

Press left key ,the image position be altered from left to right

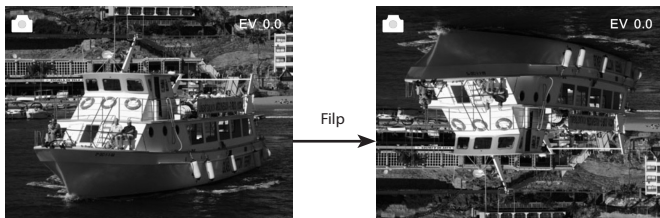

Press right key,the image position be altered from up to down

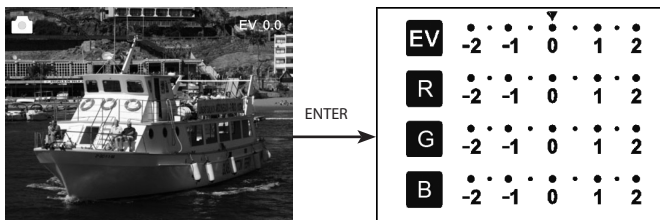

Press ENTER to set exposure compensation

5.3 Operation Guide

In main menu, press ◀ or ▶, until film mode, then press OK/ENTER you can chose negative(110, 135, 126KPK), slide(110, 135, 126KPK or Super8), B&W(110, 135, 126KPK)

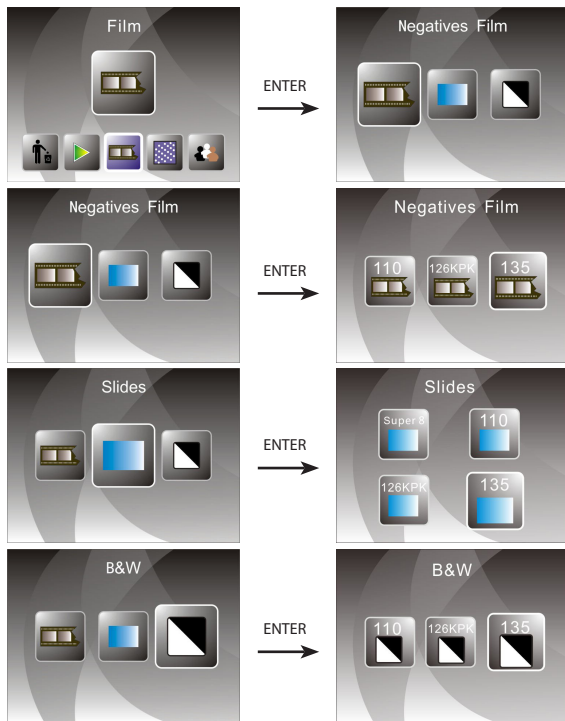

5.4 How to playback captured picture

In main menu, press ◀ or ▶, until playback mode, press OK/ENTER to the picture auto-playback mode press again to stop auto playback and you can view captured pictures manually, you can press ◀ or ▶ to view.

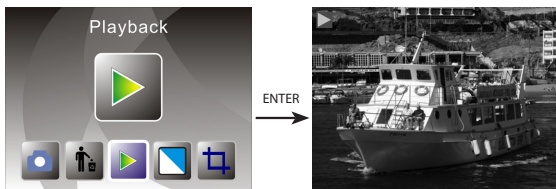

press OK/ENTER again enter picture editing mode, you can rotate, delete, exit, save, and "home" back to main menu.

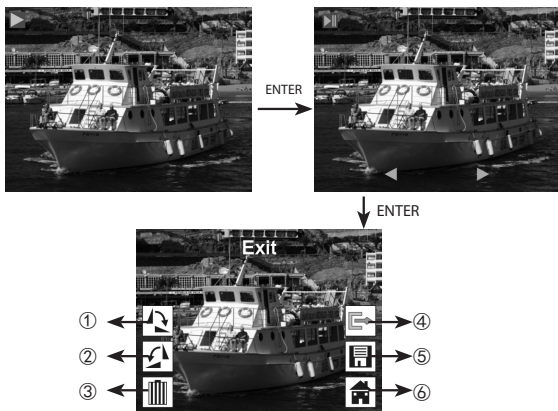

① The current picture rotate 90 degree clockwise

- ② The current picture rotate 90 degree anticlockwisely
- ③ Deleting the current picture from memory card
- ④ Exit the submenu edit mode,back
- ⑤ Saving the current edited picture
- ⑥ Exit the submenu edit mode,back to scan

5.5 Setting Language

Under main menu mode, press ◀ or ▶ until language mode, press OK/ENTER to chose language, then press ◀ or ▶ and OK/ENTER, one of following language can be set: English, German, Spanish, Portuguese, Italian, Greek, French, Dutch, Polish, Czech, Hungarian, Swedish, Finnish, Danish and Norwegian

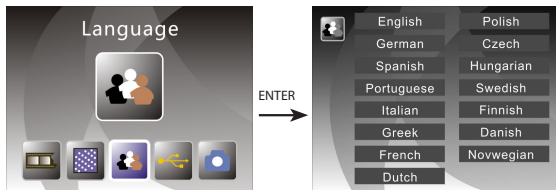

5.6 Resolution Choosing

Under main menu mode , press ◀ or ▶ until Resolution mode, press OK/ENTER to enter into Resolution choosing Mode, you can choose 14M or 22M(interpolation)

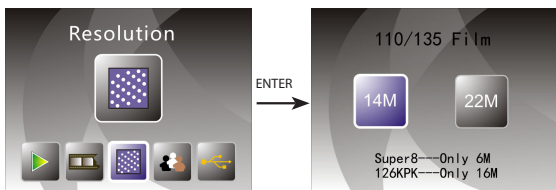

5.7 Formatting

In the main menu, press ◀ or ▶ to Format mode, press OK/ENTER button to enter.

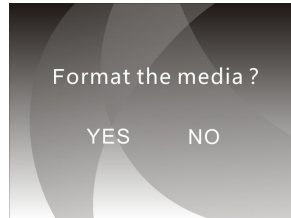
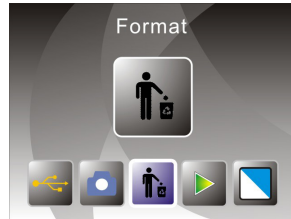
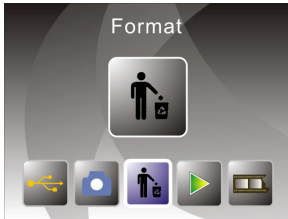

Note: After using this function, all the information in the Micro SD card will be deleted, please note it!

5.8 Connect to computer

Under main menu mode, press ◀ or ▶ until USB MSDC, press OK/ENTER after successful connecting to computer, you can view and edit captured pictures.

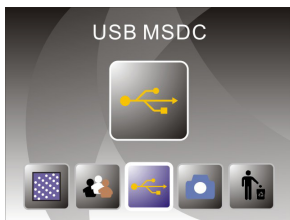

6. Product Specification

Function :	Film scanner/USB MSDC
Interface:	USB 2.0
Image Sensor :	14.0 Mega pixels(4416*3312) 1/2.3" CMOS sensor
Display:	Color 2.4" TFT LCD
Exposure Control :	Automatic / Manual (-2.0 EV~ +2.0EV)
White Balance :	Automatic
Resolution :	14.0 Mega pixels/ 22Mega pixels(interpolation)
Film type :	135 Film(36*24mm) / 126KPK Film(27*27mm) 110 Film(17*13mm)/Super8 Film(4.01*5.79mm) Monochrome, Slide
Picture Effects :	B&W,Slides,Negatives
File format :	JPEG
TV-OUT type:	NTSC/PAL
Built-in memory :	128M
External memory card:	SD card up to 32GB
Power Supply:	DC 5V Adapter/ USB Port
Language:	English, German, Spanish, Portuguese, Italian, Greek, French, Dutch, Polish, Czech, Hungarian, Swedish, Finnish, Danish and Norwegian.
Support system:	Windows XP/vista/7; Mac10.7.2 or higher
Product Size:	L91 x W104 x H105mm
Weight:	276g

MADE IN CHINA

7. Declaration

Please note products spec is subject to improvement .Any changes of product will not make additional specify.

Please Note: We reserve the right to change the appearance of the product, specifications, performance, parameters and design without prior notice. The pictures of color box and manual are for reference only. Brochure with pictures for reference,actual product and picture may be slightly different,specific please in kind prevail!

8. Disposal

Dispose of packaging: For disposal, separate packaging into different types. Cardboard and board must be disposed of as paper and foil must be recycled.



Disposal of old devices: Applicable in the European Union and other European countries with systems for the separate collection of reusable materials. Do not dispose old devices into the household waste! If the Rollei DF-S310SE is no longer used, every consumer is legally obligated to dispose them separately from the household waste, for example, at a collection site of his community / city district. This ensures that devices are properly recycled and negative effects on the environment are avoided. Therefore electrical and electronic equipment needs to be marked with the shown symbol.



9. Conformity

The Manufacturer hereby declares that the CE marking was applied to the Rollei DF-S310SE in accordance with the basic requirements and other relevant provisions of the following CE Directives:

2011/65/EC RoHs Directive
2014/30/EU EMC Directive
2006/95/EEC LVD Directive
2009/125/EG EuP Directive
2002/96/EG WEEE Directive

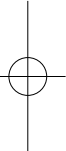

The EC Declaration of Conformity can be requested from the address specified on the Warranty card.

